

XC-SP8 Series

- Short tube designed, easy installation and maintenance.
- With Light ON and Dark ON two functions.
- Good environmental resistance up to IP67 and excellent anti noise.
- All products are CE approved.



Item	Specifications			
Model number	XC-SP8GMN	XC-SP8GMP	XC-SP8MN	XC-SP8MP
Sensing method	Through-beam			
Sensing distance	8M			
Switching output	NPN NO & NC	PNP NO & NC	NPN NO & NC	PNP NO & NC
Standard sensing object	Opaque Ø15mm			
Operating voltage	DC 12~24V±10%			
Response time	< 5ms			
Load current	< 100mA			
Light source	Infrared LED			
Operation indicator	Red LED			
Circuits protection	Reversed polarity protection			
Enclosure protection	IEC IP67			
Ambient temperature & humidity range	Operating : -20 ~ 55°C / RH 35 ~85% (with no icing or condensation)			
Ambient illumination	Lamplight < 3000 Lux / Sunlight < 10000 Lux			

Housing material	Case : ABS / Lens : Acrylic
Connecting method	Pre-wired 2M Cable
Accessories	Nuts

Dimension

XC-SP8GM□

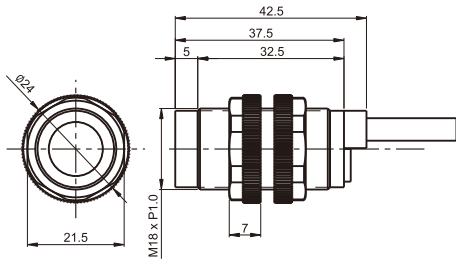

XC-SP8M□

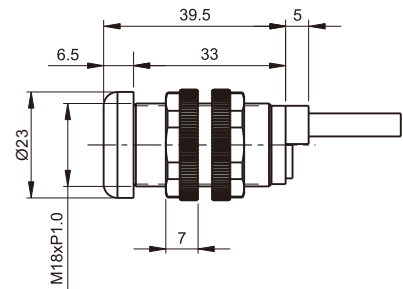

Wiring Diagram

Emitter of Thru-beam

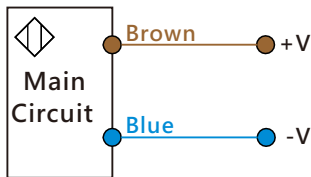

NPN NO&NC Type

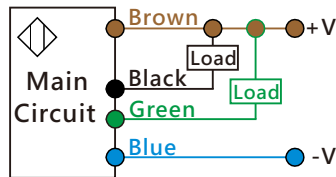

PNP NO&NC Type

